



**Hazard
Management
Services**
SINCE 1984

AHERA THREE YEAR REINSPECTION

**West Valley Christian School
Campbell, CA**

May 20, 2014

**Survey
by**

**HAZARD MANAGEMENT SERVICES, INC.
371 E. Bullard, Suite 109
Fresno, CA 93710
(559) 436-0277
www.hazmanage.com**

HAZARD MANAGEMENT SERVICES, INC.

Central California Conference of 7th Day Adventists

West Valley S.D.A Elementary

May 20, 2014

This report is broken into four main sections:

1. This Cover Letter, which is a brief summary of the suspect materials found during the inspection.
2. A Functional Space Notes (FSN) report, which is a room by room breakdown of all materials found during the inspection. The FSN is the report that is most useful for creating demolition or renovation specifications, or for notifying contractors who are working on site.
3. A Homogeneous Material Record (HMR), which is a material by material breakdown of all materials found during the inspection that are suspected to contain asbestos. This HMR satisfies the EPA's AHERA regulations for listing asbestos-containing materials. It can, also, be useful when planning renovation/demolition projects, especially those that will have all asbestos-containing materials removed.
4. The Form C Assessments are case by case assessments. This includes required response action options for all friable asbestos containing materials, all friable assumed (to contain asbestos) materials, and all Thermal System Insulation (TSI) found during the inspection. No friable materials were identified; no response action is necessary.

Also, included in this report, you will find HMS, Inc.'s Special Notes page concerning possible problems with drywall sampling and renovation/demolition projects, and a list of commonly used abbreviations that are found throughout the reports noted above.

HAZARD MANAGEMENT SERVICES, INC.

Central California Conference of 7th Day Adventists

West Valley S.D.A Elementary

May 20, 2014

At this site, West Valley S.D.A Elementary, all non-friable materials listed below were inspected and were found to be in good condition. These materials will remain non-friable as long as they are not sanded, drilled, cut or otherwise abused so that a powder is produced. Removal of these materials will require an asbestos abatement contractor, in most cases.

ACT 12" Random Hole	—MISC-Assumed	Baseboard 2" Brown-Mastic	—MISC—Assumed
Baseboard 4" Brown-Mastic	—MISC-Assumed	Baseboard 4" Green-Mastic	—MISC—Assumed
Baseboard 6" Tan-Mastic	—MISC-Assumed	Carpet Blue Multi-Mastic	—MISC—Assumed
Carpet Blue-Mastic	—MISC-Assumed	Carpet Green-Mastic	—MISC—Assumed
Ceramic tile 4" Grey w/Grout	—MISC-Assumed	Ceramic Tile 6" white w/Speck-Grout	—MISC—Assumed
Ceramic Tile Light Yellow w/Grout	—MISC-Assumed	CMU-Mortar	—MISC—Assumed
Drywall Medium Texture	—MISC-Assumed	Drywall Smooth Texture	—MISC—Assumed
Foil Tape	—MISC-Assumed	FRP White w/Mastic	—MISC—Assumed
FRP White with Scratch Pattern-Mastic	—MISC-Assumed	HVAC DuctTape	—MISC—Assumed
Linoleum Tan Squares-Mastic	—MISC-Assumed	VFT 9" Beige with Speck-Mastic	—MISC—Assumed
VFT 9" Tan with Speck-Mastic	—MISC-Assumed		

The following non-friable thermal system insulation (TSI) materials were found at this site. Even though these materials are technically friable by definition, they may be treated as non-friable materials as long as they remain in an intact condition. A Form C and an evaluation sheet are included for these materials.

NONE

The following friable asbestos-containing materials were noted at this site. Friable materials are those that can release asbestos fibers with a minimum of contact or disturbance. Friable asbestos-containing materials can only be handled by an asbestos abatement contractor. Evaluation sheets and Form Cs are provided for the materials listed.

NONE

See "Special Notes" section concerning drywall sampling and renovations/demolitions. This page contains valuable information which must be considered before any alterations, modernization, renovations or demolitions occur.

HAZARD MANAGEMENT SERVICES, INC.

Central California Conference of 7th Day Adventists

West Valley S.D.A Elementary

May 20, 2014

Following the "Special Notes" and "Abbreviations" pages you will find the "Homogeneous Materials Record (HMR)". The HMR lists each suspect material (asbestos-containing or not), sample numbers, the location of the material in each building, the percent asbestos of each suspect material, the approximate square footage of each material in these locations and the friability of the material. When you use the HMR sheets you can pick a material and then go through the list and note every location where that material is located.

All materials not identified in this report that are discovered at the site must be assumed to contain asbestos until sampled and proven otherwise. Although there may be materials that have been excluded from the AHERA Management Plan by a letter stating it is non-asbestos-containing, the EPA's "National Emission Standards for Hazardous Air Pollutants (NESHAP)" does not allow for materials to be considered non-asbestos through the use of written documentation. This makes it necessary to bulk sample materials to prove they are non-asbestos-containing prior to renovations, demolitions and modernizations, no matter when they were installed.

Be sure to add this report to your management plan at the facilities office.

Date Printed: 8/19/2014

Functional Space Notes

HAZARD MANAGEMENT SERVICES, INC.

Client: Central California Conference of 7th Day Adventist Site: West Valley S.D.A Elementary
HMS Project Number: F14031M Date of Inspection: May 20, 2014

Materials		Material Class	Percent Asbestos	Hmgns Matrl #	Sampled Here?	Footage Sq/Ln/Jnts	Friable? Yes/No
Building: Main Building		Room: 01-Hallway - 78 x 6 x 8					
Floor:	VFT 9" Tan with Speck-Mastic	MISC	Assumed	1		468 sq	No
Baseboard:	Baseboard 2" Brown-Mastic	MISC	Assumed	2		168 ln	No
Walls:	Drywall Medium Texture	MISC	Assumed	3		1344 sq	No
Ceiling:	ACT 12" Random Hole	MISC	Assumed	4		468 sq	No
<i>Comment: Appear to be Glued on to Drywall. Some imact damage to approximately 10%</i>							
Ceiling:	Drywall Medium Texture	MISC	Assumed	3		468 sq	No
Room Comments:	<i>L shaped through lower floor of building</i>						
Building: Main Building		Room: 03-Grades K thru 2nd - 36 x 36 x 10					
Floor:	Carpet Blue Multi-Mastic	MISC	Assumed	5		1296 sq	No
Baseboard:	Wood 2"	NON	Non-Suspect				
<i>Comment: Appears to be nailed on to wall</i>							
Walls:	Drywall Medium Texture	MISC	Assumed	3		1440 sq	No
Ceiling:	ACT 12" Random Hole	MISC	Assumed	4		1296 sq	No
<i>Comment: Appears to be glued on.</i>							
Building: Main Building		Room: 04-Grades 3 thru 4 - 36 x 30 x 10					
Floor:	Carpet Blue Multi-Mastic	MISC	Assumed	5		1080 sq	No
Baseboard:	Wood 2"	NON	Non-Suspect				
Walls:	Drywall Medium Texture	MISC	Assumed	3		1320 sq	No
Ceiling:	ACT 12" Random Hole	MISC	Assumed	4		1080 sq	No
Counter Top:	Ceramic tile 4" Grey w/Grout	MISC	Assumed	6		100 sq	No
Building: Main Building		Room: 05-Custodial Closet - 7 x 6 x 9					
Floor:	Concrete	NON	Non-Suspect				
Baseboard:	None	NON	Non-Suspect				
Walls:	Drywall Medium Texture	MISC	Assumed	3		234 sq	No
Ceiling:	Drywall Medium Texture	MISC	Assumed	3		42 sq	No
Room Comments:	<i>Located in Hall way near Women's restroom</i>						

Functional Space Notes

HAZARD MANAGEMENT SERVICES, INC.

Client: Central California Conference of 7th Day Adventist Site: West Valley S.D.A Elementary
HMS Project Number: F14031M Date of Inspection: May 20, 2014

Materials		Material Class	Percent Asbestos	Hmgns Matrl #	Sampled Here?	Footage Sq/Ln/Jnts	Friable? Yes/No
Building: Main Building		Room: 06-Womens Restroom Foyer - 5 x 5 x 9					
Floor:	Linoleum Tan Squares-Mastic	MISC	Assumed	7		25 sq	No
Baseboard:	Baseboard 6" Tan-Mastic	MISC	Assumed	8		20 ln	No
Walls:	Drywall Medium Texture	MISC	Assumed	3		180 sq	No
Ceiling:	Drywall Medium Texture	MISC	Assumed	3		25 sq	No
<i>Comment: Attic Access</i>							
Building: Main Building		Room: 07-Womens Restroom - 15 x 12 x 9					
Floor:	Linoleum Tan Squares-Mastic	MISC	Assumed	7		180 sq	No
Baseboard:	Baseboard 6" Tan-Mastic	MISC	Assumed	8		54 ln	No
Walls:	Drywall Smooth Texture	MISC	Assumed	9		486 sq	No
Walls:	FRP White with Scratch Pattern-Mastic	MISC	Assumed	10			No
Ceiling:	Drywall Smooth Texture	MISC	Assumed	9		180 sq	No
Building: Main Building		Room: 08-Teachers Workroom - 24 x 11 x 8					
Floor:	VFT 9" Tan with Speck-Mastic	MISC	Assumed	1		264 sq	No
Baseboard:	Baseboard 2" Brown-Mastic	MISC	Assumed	2		70 ln	No
Walls:	Drywall Medium Texture	MISC	Assumed	3		560 sq	No
Ceiling:	ACT 12" Random Hole	MISC	Assumed	4		264 sq	No
<i>Comment: Glued to Drywall Ceiling</i>							
Ceiling:	Drywall Medium Texture	MISC	Assumed	3		264 sq	No
Counter Top:	Ceramic tile 4" Grey w/Grout	MISC	Assumed	6		70 sq	No
Building: Main Building		Room: 09-Kitchen - 32 x 18 x 9					
Floor:	VFT 9" Beige with Speck-Mastic	MISC	Assumed	11		576 sq	No
Baseboard:	Baseboard 4" Brown-Mastic	MISC	Assumed	12		50 ln	No
Baseboard:	Baseboard 4" Green-Mastic	MISC	Assumed	13		50 ln	No
Walls:	Drywall Medium Texture	MISC	Assumed	3		450 sq	No
Walls:	Drywall Smooth Texture	MISC	Assumed	9		450 sq	No
Ceiling:	Drywall Medium Texture	MISC	Assumed	3		288 sq	No
Ceiling:	Drywall Smooth Texture	MISC	Assumed	9		288 sq	No
Counter Top:	Ceramic Tile 6" white w/Speck-Grout	MISC	Assumed	14			No

Functional Space Notes

HAZARD MANAGEMENT SERVICES, INC.

Client: Central California Conference of 7th Day Adventist Site: West Valley S.D.A Elementary
HMS Project Number: F14031M Date of Inspection: May 20, 2014

Materials		Material Class	Percent Asbestos	Hmgns Matrl #	Sampled Here?	Footage Sq/Ln/Jnts	Friable? Yes/No
Building: Main Building		Room: 10-Mens Restroom Foyer - 5 x 5 x 9					
Floor:	Linoleum Tan Squares-Mastic	MISC	Assumed	7		25 sq	No
Baseboard:	Baseboard 6" Tan-Mastic	MISC	Assumed	8		20 ln	No
Walls:	Drywall Medium Texture	MISC	Assumed	3		180 sq	No
Ceiling:	Drywall Medium Texture	MISC	Assumed	3		25 sq	No
<i>Comment: Attic Access</i>							
Building: Main Building		Room: 11-Mens Restroom - 15 x 12 x 9					
Floor:	Linoleum Tan Squares-Mastic	MISC	Assumed	7		180 sq	No
Baseboard:	Baseboard 6" Tan-Mastic	MISC	Assumed	8		54 ln	No
Walls:	Drywall Smooth Texture	MISC	Assumed	9		486 sq	No
Walls:	FRP White w/Mastic	MISC	Assumed	15		486	No
Ceiling:	Drywall Smooth Texture	MISC	Assumed	9		180 sq	No
Building: Main Building		Room: 12-Second Floor Hallway - 82 x 6 x 8					
Floor:	Carpet Blue-Mastic	MISC	Assumed	16		492 sq	No
Baseboard:	Wood 2"	NON	Non-Suspect				
Walls:	Drywall Medium Texture	MISC	Assumed	3		1408 sq	No
Ceiling:	ACT 12" Random Hole	MISC	Assumed	4		492 sq	No
Ceiling:	Drywall Medium Texture	MISC	Assumed	3		492 sq	No
Building: Main Building		Room: 13-A4-Music - 36 x 36 x 10					
Floor:	Carpet Blue Multi-Mastic	MISC	Assumed	5		1296 sq	No
Baseboard:	Wood 2"	NON	Non-Suspect				
Walls:	Drywall Medium Texture	MISC	Assumed	3		1440 sq	No
Ceiling:	ACT 12" Random Hole	MISC	Assumed	4		1296 sq	No
Ceiling:	Drywall Medium Texture	MISC	Assumed	3		1296 sq	No
Counter Top:	Ceramic Tile Light Yellow w/Grout	MISC	Assumed	17		38 sq	No
Building: Main Building		Room: 14-A5 - 54 x 36 x 10					
Floor:	VFT 9" Tan with Speck-Mastic	MISC	Assumed	1		1944 sq	No
Baseboard:	Baseboard 2" Brown-Mastic	MISC	Assumed	2		180 ln	No
Walls:	Drywall Medium Texture	MISC	Assumed	3		1800 sq	No
Ceiling:	ACT 12" Random Hole	MISC	Assumed	4		1944 sq	No
<i>Comment: Appear to be Glued on</i>							
Ceiling:	Drywall Medium Texture	MISC	Assumed	3		1944 sq	No

Functional Space Notes

HAZARD MANAGEMENT SERVICES, INC.

Client: Central California Conference of 7th Day Adventist Site: West Valley S.D.A Elementary

HMS Project Number: F14031M

Date of Inspection: May 20, 2014

Materials	Material Class	Percent Asbestos	Hmgns Matrl #	Sampled Here?	Footage Sq/Ln/Jnts	Friable? Yes/No
Building: Main Building		Room: 15-A5-HVAC Closet - 7 x 12 x 8				
Floor:	VFT 9" Tan with Speck-Mastic	MISC	Assumed	1	84 sq	No
Baseboard:	Baseboard 2" Brown-Mastic	MISC	Assumed	2	38 ln	No
Walls:	Drywall Medium Texture	MISC	Assumed	3	304 sq	No
	<i>Comment: 5% Damaged due to scraping</i>					
Ceiling:	Drywall Medium Texture	MISC	Assumed	3	84 sq	No
	<i>Comment: Damage of 5% due to Water Leakage</i>					
HVAC Tape:	Foil Tape	MISC	Assumed	19	50 ln	No
Duct Tape:	HVAC Duct Tape	MISC	Assumed	18	30 ln	No
Building: Main Building		Room: 17-A3-Classroom - 36 x 36 x 10				
Floor:	Carpet Blue Multi-Mastic	MISC	Assumed	5	1296 sq	No
Baseboard:	Wood 2"	NON	Non-Suspect			
Walls:	CMU-Mortar	MISC	Assumed	20	144 sq	No
Walls:	Drywall Medium Texture	MISC	Assumed	3	1440 sq	No
Ceiling:	ACT 12" Random Hole	MISC	Assumed	4	1296 sq	No
Ceiling:	Drywall Medium Texture	MISC	Assumed	3	1296 sq	No
Counter Top:	Ceramic Tile Light Yellow w/Grout	MISC	Assumed	17		No
Building: Main Building		Room: 18-Attic-First Floor - 70 x 70 x 3				
Floor:	Drywall Medium Texture	MISC	Assumed	3	4900 sq	No
Walls:	Wood -	NON	Non-Suspect			
Ceiling:	Wood -	NON	Non-Suspect			
Ducts:	Metal	NON	Non-Suspect			
	<i>Comment: No Duct Tape Noted</i>					
Pipes:	Metal	NON	Non-Suspect			
Building: Main Building		Room: 18-Office - 24 x 18 x 8				
Floor:	Carpet Green-Mastic	MISC	Assumed	21	432 sq	No
Baseboard:	Wood 2"	NON	Non-Suspect			
Walls:	Drywall Medium Texture	MISC	Assumed	3	672 sq	No
Ceiling:	Drywall Medium Texture	MISC	Assumed	3	432 sq	No

Functional Space Notes

HAZARD MANAGEMENT SERVICES, INC.

Client: Central California Conference of 7th Day Adventist Site: West Valley S.D.A Elementary

HMS Project Number: F14031M

Date of Inspection: May 20, 2014

Materials		Material Class	Percent Asbestos	Hmgns Matrl #	Sampled Here?	Footage Sq/Ln/Jnts	Friable? Yes/No
Building: Main Building		Room: 19-Small Office - 9 x 9 x 8					
Floor:	Carpet Blue-Mastic	MISC	Assumed	16		81 sq	No
Baseboard:	None	NON	Non-Suspect				
Walls:	Drywall Medium Texture	MISC	Assumed	3		288 sq	No
Ceiling:	Drywall Medium Texture	MISC	Assumed	3		81 sq	No
Building: Main Building		Room: 20-Princiipals Office - 20 x 12 x 8					
Floor:	Carpet Green-Mastic	MISC	Assumed	21		240 sq	No
Baseboard:	Wood 2"	NON	Non-Suspect				
Walls:	Drywall Medium Texture	MISC	Assumed	3		512 sq	No
Ceiling:	Drywall Medium Texture	MISC	Assumed	3		240 sq	No

Functional Space Notes

HAZARD MANAGEMENT SERVICES, INC.

Client: Central California Conference of 7th Day Adventist Site: West Valley S.D.A Elementary
HMS Project Number: F14031M Date of Inspection: May 20, 2014

Non-Inspected Rooms and Comments:

Main Building - 02-Office

Main Building - 16-Attic-Second Floor: Inaccessible due to storage-Access is in HVAC Closet

Main Building - Basement

Main Building - Exterior

HAZARD MANAGEMENT SERVICES, INC.

Abbreviations

The following list includes most of the abbreviations you may find within this report.

ACT:	Acoustic Ceiling/Wall Tile
B-I-I:	Blown-In-Insulation
BLR:	Boiler
C'Ing	Ceiling
Carp:	Carpet
Carp&Mast	Carpet and Mastic
Bsbrd&Glue	Baseboard and Glue
DIP:	Drop In Panel
DIT:	Drop In Tile
FCP:	False Ceiling Panel
FRP:	Fiberglass Reinforced Plastic
FG:	Fiberglass
HMR #:	Homogeneous Material Number
HTR:	Heater
LINO:	Linoleum
MISC	Miscellaneous
PW:	Pipe Wrap
S-O-C:	Sprayed-On Ceiling
SOFP:	Sprayed on Fire Proofing
S-O-W:	Sprayed-On Wall
SURF:	Surfacing
T-O-C:	Troweled-On Ceiling
T-O-W:	Troweled-On Wall
TSI:	Thermal System Insulation
VFT:	Vinyl Floor Tile
W & C:	Walls and Ceilings

HAZARD MANAGEMENT SERVICES, INC.

Special Notes

SPECIAL NOTE NO. 1 - DRYWALL/SHEETROCK

Drywall and its components continue to present problems both for our clients and for us. The inconsistency of sample results indicates that even the EPA/AHERA method for sampling drywall is inadequate. Although three to fifteen or more drywall samples may have been collected at your site(s), the results may not be representative of what is present. Asbestos sometimes is found in the drywall itself, in its tape and/or joint compound or in the final texture coat applied to finish the appearance. It can be found in any combination in these materials. It can also be found in patching materials used to repair damaged drywall. Paint added to otherwise non-homogeneous materials can also produce inappropriate assumptions that all materials are the same.

To account for the variability in drywall construction we strongly advise that any substantial renovation project involving drywall be preceded by a comprehensive evaluation of the materials designated for handling.

SPECIAL NOTE NO. 2 - RENOVATIONS/DEMOLITIONS

Please be aware that many possible asbestos-containing materials were specifically exempted from inspection and identification by the AHERA sampling protocol. These exempted materials included roofing materials, most exterior plasters, exterior window putty, exterior transite panels and shingles, some exterior thermal system insulation and a few other materials. AHERA also exempted heat resistant counter tops and transite blackboards and a few other materials found inside of buildings.

While these materials are exempted by AHERA, they are not exempted by Cal/OSHA or EPA's regulation in its "National Emission Standards for Hazardous Air Pollutants" (NESHAP). Therefore, any renovation activity involving these materials must be preceded by a sampling project to identify asbestos-containing materials which may be regulated by these agencies or the local Air Pollution Control District. You cannot rely on you AHERA reports to identify all of these additional materials.

SPECIAL NOTE NO. 3 - NEW MATERIALS AND BUILDINGS

Materials installed since the previous inspection must be certified, in writing, as non-asbestos containing materials, sampled to test for asbestos content, or assumed to contain asbestos. This certification must be from the product manufacturer or the construction engineer on the project during which the new materials were installed. This certification must be placed in your management plan.

Buildings installed (portables) or constructed since October 12, 1988 must be certified to be asbestos-containing building material (ACBMs) free by the manufacturer (portables), architect or construction engineer, or they must be inspected for ACBMs. This certification must be placed in the management plan for the site at which the new building was installed or constructed.

New sites, built after October 12, 1988, require a Management Plan. If ACBM free certification letters are obtainable for all buildings at the new site, no inspection is required, although a Management Plan must still be written.

SPECIAL NOTE NO. 4 - Materials Containing Trace Amounts of Asbestos

Materials containing trace amounts of asbestos are not covered by the AHERA regulations as the EPA does not consider them to be asbestos-containing materials. However, Cal/OSHA does consider materials containing trace amounts of asbestos (down to 0.1%) to be asbestos-containing, and any level of asbestos in a material must be considered a potential exposure hazard.

Materials listed as containing trace amounts of asbestos require special handling procedures - per Cal/OSHA and training for the employees working with these materials. Waste materials containing less than 1% asbestos must be "point counted" or handled as a hazardous waste.

Homogeneous Material Records

HAZARD MANAGEMENT SERVICES, INC.

Client: Central California Conference of 7th Day Adventist

Site: West Valley S.D.A Elementary

Project #: F14031M

Building: Main Building

Inspection Date: 5/20/2014

Material	Class	HMR	Sample Number(s)	Location	% Asbestos	Footage	Friable
VFT 9" Tan with Speck-Mastic	MISC	1	NOT SAMPLED	01-Hallway L shaped through lower floor of building - Floor	Assumed	468 Square	No
VFT 9" Tan with Speck-Mastic	MISC	1	NOT SAMPLED	08-Teachers Workroom - Floor	Assumed	264 Square	No
VFT 9" Tan with Speck-Mastic	MISC	1	NOT SAMPLED	14-A5 - Floor	Assumed	1944 Square	No
VFT 9" Tan with Speck-Mastic	MISC	1	NOT SAMPLED	15-A5-HVAC Closet - Floor	Assumed	84 Square	No
Baseboard 2" Brown-Mastic	MISC	2	NOT SAMPLED	01-Hallway L shaped through lower floor of building - Baseboard	Assumed	168 Linear	No
Baseboard 2" Brown-Mastic	MISC	2	NOT SAMPLED	08-Teachers Workroom - Baseboard	Assumed	70 Linear	No
Baseboard 2" Brown-Mastic	MISC	2	NOT SAMPLED	14-A5 - Baseboard	Assumed	180 Linear	No
Baseboard 2" Brown-Mastic	MISC	2	NOT SAMPLED	15-A5-HVAC Closet - Baseboard	Assumed	38 Linear	No
Drywall Medium Texture	MISC	3	NOT SAMPLED	01-Hallway L shaped through lower floor of building - Walls/Ceiling	Assumed	1812 Square	No
Drywall Medium Texture	MISC	3	NOT SAMPLED	03-Grades K thru 2nd - Walls	Assumed	1440 Square	No
Drywall Medium Texture	MISC	3	NOT SAMPLED	04-Grades 3 thru 4 - Walls	Assumed	1320 Square	No
Drywall Medium Texture	MISC	3	NOT SAMPLED	05-Custodial Closet Located in Hall way near Women's restroom - Walls/Ceiling	Assumed	276 Square	No

Homogeneous Material Records

HAZARD MANAGEMENT SERVICES, INC.

Client: Central California Conference of 7th Day
Adventist

Site: West Valley S.D.A Elementary

Project #: F14031M

Building: Main Building

Inspection Date: 5/20/2014

Material	Class	HMR	Sample Number(s)	Location	% Asbestos	Footage	Friable
Drywall Medium Texture	MISC	3	NOT SAMPLED	06-Womens Restroom Foyer - Walls/Ceiling	Assumed	205 Square	No
Drywall Medium Texture	MISC	3	NOT SAMPLED	08-Teachers Workroom - Walls/Ceiling	Assumed	824 Square	No
Drywall Medium Texture	MISC	3	NOT SAMPLED	09-Kitchen - Walls/Ceiling	Assumed	738 Square	No
Drywall Medium Texture	MISC	3	NOT SAMPLED	10-Mens Restroom Foyer - Walls/Ceiling	Assumed	205 Square	No
Drywall Medium Texture	MISC	3	NOT SAMPLED	12-Second Floor Hallway - Walls/Ceiling	Assumed	1900 Square	No
Drywall Medium Texture	MISC	3	NOT SAMPLED	13-A4-Music - Walls/Ceiling	Assumed	2736 Square	No
Drywall Medium Texture	MISC	3	NOT SAMPLED	14-A5 - Walls/Ceiling	Assumed	3744 Square	No
Drywall Medium Texture	MISC	3	NOT SAMPLED	15-A5-HVAC Closet - Walls/Ceiling 5% Damaged due to scraping	Assumed	388 Square	No
Drywall Medium Texture	MISC	3	NOT SAMPLED	17-A3-Classroom - Walls/Ceiling	Assumed	2736 Square	No
Drywall Medium Texture	MISC	3	NOT SAMPLED	18-Attic-First Floor - Floor	Assumed	4900 Square	No
Drywall Medium Texture	MISC	3	NOT SAMPLED	18-Office - Walls/Ceiling	Assumed	1104 Square	No
Drywall Medium Texture	MISC	3	NOT SAMPLED	19-Small Office - Walls/Ceiling	Assumed	369 Square	No
Drywall Medium Texture	MISC	3	NOT SAMPLED	20-Principals Office - Walls/Ceiling	Assumed	752 Square	No

Homogeneous Material Records

HAZARD MANAGEMENT SERVICES, INC.

Client: Central California Conference of 7th Day Adventist

Site: West Valley S.D.A Elementary

Project #: F14031M

Building: Main Building

Inspection Date: 5/20/2014

Material	Class	HMR	Sample Number(s)	Location	% Asbestos	Footage	Friable
ACT 12" Random Hole	MISC	4	NOT SAMPLED	01-Hallway L shaped through lower floor of building - Ceiling Appear to be Glued on to Drywall. Some impact damage to approximately 10%	Assumed	468 Square	No
ACT 12" Random Hole	MISC	4	NOT SAMPLED	03-Grades K thru 2nd - Ceiling Appears to be glued on.	Assumed	1296 Square	No
ACT 12" Random Hole	MISC	4	NOT SAMPLED	04-Grades 3 thru 4 - Ceiling	Assumed	1080 Square	No
ACT 12" Random Hole	MISC	4	NOT SAMPLED	08-Teachers Workroom - Ceiling Glued to Drywall Ceiling	Assumed	264 Square	No
ACT 12" Random Hole	MISC	4	NOT SAMPLED	12-Second Floor Hallway - Ceiling	Assumed	492 Square	No
ACT 12" Random Hole	MISC	4	NOT SAMPLED	13-A4-Music - Ceiling	Assumed	1296 Square	No
ACT 12" Random Hole	MISC	4	NOT SAMPLED	14-A5 - Ceiling Appear to be Glued on	Assumed	1944 Square	No
ACT 12" Random Hole	MISC	4	NOT SAMPLED	17-A3-Classroom - Ceiling	Assumed	1296 Square	No
Carpet Blue Multi-Mastic	MISC	5	NOT SAMPLED	03-Grades K thru 2nd - Floor	Assumed	1296 Square	No
Carpet Blue Multi-Mastic	MISC	5	NOT SAMPLED	04-Grades 3 thru 4 - Floor	Assumed	1080 Square	No
Carpet Blue Multi-Mastic	MISC	5	NOT SAMPLED	13-A4-Music - Floor	Assumed	1296 Square	No
Carpet Blue Multi-Mastic	MISC	5	NOT SAMPLED	17-A3-Classroom - Floor	Assumed	1296 Square	No

Homogeneous Material Records

HAZARD MANAGEMENT SERVICES, INC.

Client: Central California Conference of 7th Day Adventist

Site: West Valley S.D.A Elementary

Project #: F14031M

Building: Main Building

Inspection Date: 5/20/2014

Material	Class	HMR	Sample Number(s)	Location	% Asbestos	Footage	Friable
Ceramic tile 4" Grey w/Grout	MISC	6	NOT SAMPLED	04-Grades 3 thru 4 - Counter Top	Assumed	100 Square	No
Ceramic tile 4" Grey w/Grout	MISC	6	NOT SAMPLED	08-Teachers Workroom - Counter Top	Assumed	70 Square	No
Linoleum Tan Squares-Mastic	MISC	7	NOT SAMPLED	06-Womens Restroom Foyer - Floor	Assumed	25 Square	No
Linoleum Tan Squares-Mastic	MISC	7	NOT SAMPLED	07-Womens Restroom - Floor	Assumed	180 Square	No
Linoleum Tan Squares-Mastic	MISC	7	NOT SAMPLED	10-Mens Restroom Foyer - Floor	Assumed	25 Square	No
Linoleum Tan Squares-Mastic	MISC	7	NOT SAMPLED	11-Mens Restroom - Floor	Assumed	180 Square	No
Baseboard 6" Tan-Mastic	MISC	8	NOT SAMPLED	06-Womens Restroom Foyer - Baseboard	Assumed	20 Linear	No
Baseboard 6" Tan-Mastic	MISC	8	NOT SAMPLED	07-Womens Restroom - Baseboard	Assumed	54 Linear	No
Baseboard 6" Tan-Mastic	MISC	8	NOT SAMPLED	10-Mens Restroom Foyer - Baseboard	Assumed	20 Linear	No
Baseboard 6" Tan-Mastic	MISC	8	NOT SAMPLED	11-Mens Restroom - Baseboard	Assumed	54 Linear	No
Drywall Smooth Texture	MISC	9	NOT SAMPLED	07-Womens Restroom - Walls/Ceiling	Assumed	666 Square	No
Drywall Smooth Texture	MISC	9	NOT SAMPLED	09-Kitchen - Walls/Ceiling	Assumed	738 Square	No
Drywall Smooth Texture	MISC	9	NOT SAMPLED	11-Mens Restroom - Walls/Ceiling	Assumed	666 Square	No
FRP White with Scratch Pattern-Mastic	MISC	10	NOT SAMPLED	07-Womens Restroom - Walls	Assumed		No

Homogeneous Material Records

HAZARD MANAGEMENT SERVICES, INC.

Client: Central California Conference of 7th Day Adventist

Site: West Valley S.D.A Elementary

Project #: F14031M

Building: Main Building

Inspection Date: 5/20/2014

Material	Class	HMR	Sample Number(s)	Location	% Asbestos	Footage	Friable
VFT 9" Beige with Speck-Mastic	MISC	11	NOT SAMPLED	09-Kitchen - Floor	Assumed	576 Square	No
Baseboard 4" Brown-Mastic	MISC	12	NOT SAMPLED	09-Kitchen - Baseboard	Assumed	50 Linear	No
Baseboard 4" Green-Mastic	MISC	13	NOT SAMPLED	09-Kitchen - Baseboard	Assumed	50 Linear	No
Ceramic Tile 6" white w/Speck-Grout	MISC	14	NOT SAMPLED	09-Kitchen - Counter Top	Assumed		No
FRP White w/Mastic	MISC	15	NOT SAMPLED	11-Mens Restroom - Walls	Assumed	486	No
Carpet Blue-Mastic	MISC	16	NOT SAMPLED	12-Second Floor Hallway - Floor	Assumed	492 Square	No
Carpet Blue-Mastic	MISC	16	NOT SAMPLED	19-Small Office - Floor	Assumed	81 Square	No
Ceramic Tile Light Yellow w/Grout	MISC	17	NOT SAMPLED	13-A4-Music - Counter Top	Assumed	38 Square	No
Ceramic Tile Light Yellow w/Grout	MISC	17	NOT SAMPLED	17-A3-Classroom - Counter Top	Assumed	Square	No
HVAC Duct Tape	MISC	18	NOT SAMPLED	15-A5-HVAC Closet - Duct Tape	Assumed	30 Linear	No
Foil Tape	MISC	19	NOT SAMPLED	15-A5-HVAC Closet - HVAC Tape	Assumed	50 Linear	No
CMU-Mortar	MISC	20	NOT SAMPLED	17-A3-Classroom - Walls	Assumed	144 Square	No
Carpet Green-Mastic	MISC	21	NOT SAMPLED	18-Office - Floor	Assumed	432 Square	No
Carpet Green-Mastic	MISC	21	NOT SAMPLED	20-Principals Office - Floor	Assumed	240 Square	No

Homogeneous Material Records

HAZARD MANAGEMENT SERVICES, INC.

Client: Central California Conference of 7th Day
Adventist

Site: West Valley S.D.A Elementary

Project #: F14031M

Building: Main Building

Inspection Date: 5/20/2014

Material	Class	HMR	Sample Number(s)	Location	% Asbestos	Footage	Friable
Concrete	NON	0	NOT SAMPLED	05-Custodial Closet Located in Hall way near Women's restroom - Floor	Non-Suspect	42 Square	No
Metal	NON	0	NOT SAMPLED	18-Attic-First Floor - Pipes/Ducts	Non-Suspect	280 Linear	No
None	NON	0	NOT SAMPLED	Various Locations Located in Hall way near Women's restroom	Non-Suspect		
Wood -	NON	0	NOT SAMPLED	18-Attic-First Floor - Walls/Ceiling	Non-Suspect	5740 Square	No
Wood 2"	NON	0	NOT SAMPLED	Various Locations Appears to be nailed on to wall	Non-Suspect		

West Valley Christian School
95 Dot Avenue
Campbell, Ca 95008

Fire Escape Routes
1st Floor

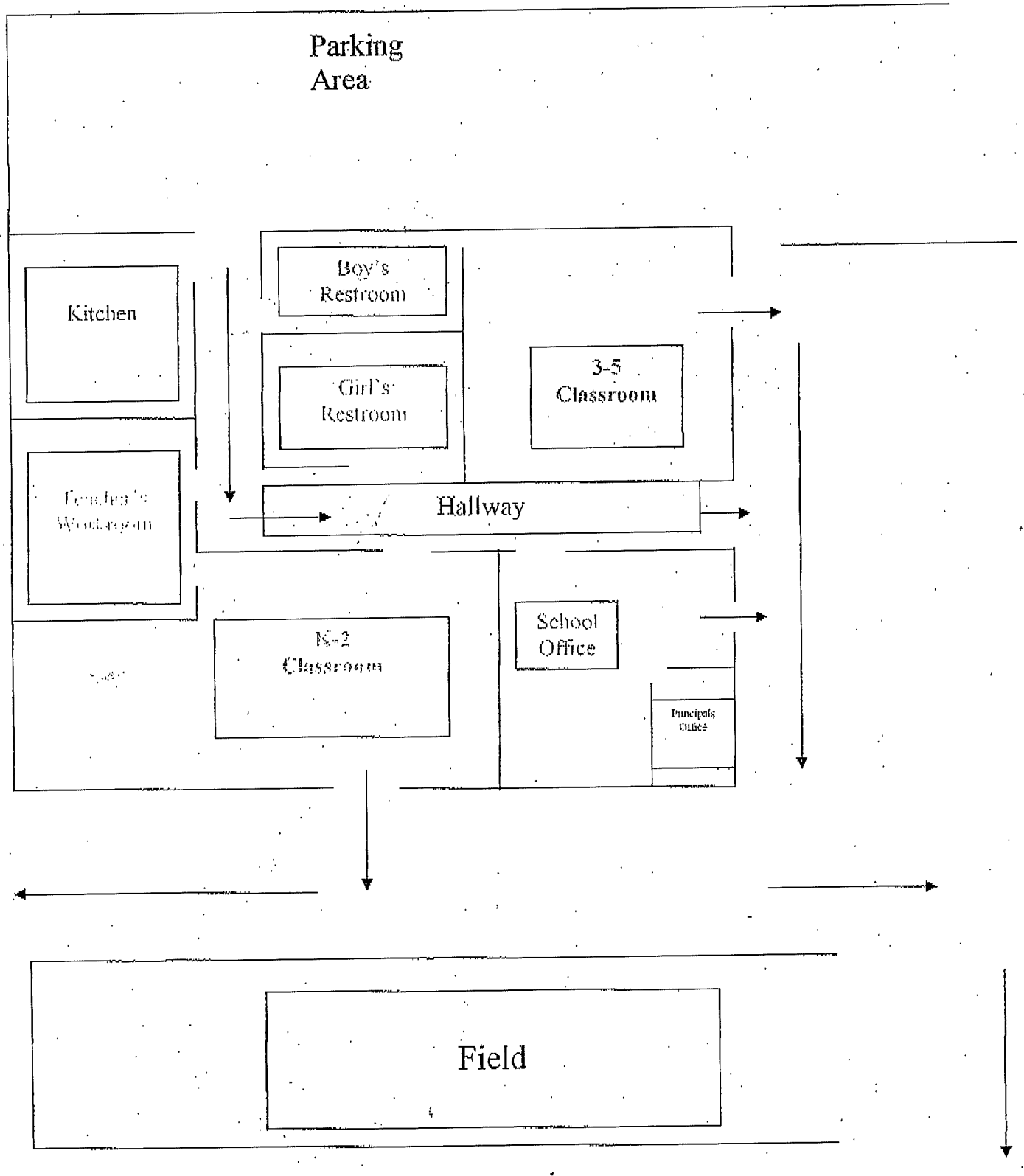

ASBESTOS HAZARD EMERGENCY RESPONSE ACT (AHERA)
GENERAL DATA
(FORM A)

Inspection Date: May 20, 2014

LOCAL EDUCATION AGENCY				COUNTY	
Central California Conference of 7th Day Adventist				Santa Clara	
SCHOOL NAME				SCHOOL PHONE NUMBER	
West Valley S.D.A Elementary				(408) 378 - 4327	
ADDRESS (Number)		(Street)	(City)	(State)	(Zip)
95 Dot Avenue			Campbell	CA	95008
CDS CODE*	SCHOOL ENROLLMENT*	NO. SCHOOL EMPLOYEES*		NO. BUILDINGS AT SCHOOL	
43-69393-6980353	27	3		3	

LEA AHERA DESIGNEE

NAME			PHONE NUMBER		
Todd Paige			(559) 347-3121		
ADDRESS (Number)		(Street)	(City)	(State)	(Zip)
2820 Willow Ave,		Clovis,	CA	93612	
TRAINING COURSE(S) AND DATE(S)					
Hazard Management Services, Inc. LEA Designee, 8-25-14					
			TOTAL TRAINING HOURS		
			0 6		

MANAGEMENT PLANNER

NAME			PHONE NUMBER		
Ken Meadows			(209) 551 - 2000		
ADDRESS (Number)		(Street)	(City)	(State)	(Zip)
207 McHenry Ave			Modesto	CA	95355-1755
ACCREDITATION NUMBER		TRAINING AGENCY			
MP-R-68-14		Wangerin Environmental			

DOCUMENTS ATTACHED (CHECK APPROPRIATE BOXES)

<input checked="" type="checkbox"/> Record of Friable and Non-Friable ACBM (Form B)	<input checked="" type="checkbox"/> Physical and Hazard Assessment of Friable ACBM or Friable Assumed ACBM (Form C)	<input type="checkbox"/> Operations and Maintenance Program	<input type="checkbox"/> Periodic Surveillance Plan
<input type="checkbox"/> Reinspection Plan (Form F)	<input type="checkbox"/> Parent/Employee Notification	<input type="checkbox"/> Resources Needed (Form H)	

We certify that the general Local Education Agency (LEA) responsibilities, as stipulated by 40 CFR Part 763, have been met or will be met and that this Management Plan includes all buildings at this school.

MANAGEMENT PLANNER SIGNATURE	DATE
	10/17/14
LEA DESIGNEE SIGNATURE	DATE
LEA SUPERINTENDENT SIGNATURE	DATE

Date Printed: 8/19/2014

RECORD OF FRIABLE AND NONFRIABLE ACM (FORM B)

Inspection Date: May 20, 2014

					CDS CODE	
					43-69393-6980353	
SCHOOL					SCHOOL PHONE NUMBER	
West Valley S.D.A Elementary					(408) 378 - 4327	
ADDRESS		(Number)	(Street)	(City)	(State)	(Zip)
95 Dot Avenue				Campbell	CA	95008

- IMPORTANT -

Each building and functional space with friable ACBM or friable assumed ACBM listed on this form requires completion of FORM C (PHYSICAL AND HAZARD ASSESSMENT OF FRIABLE ACBM OR FRIABLE ASSUMED ACBM). Indicate location of material on blueprint, diagram or narrative in square or linear feet, and attach a copy (Sec. 763.93).

LINE	BUILDING NAME & FUNCTIONAL SPACE (Indicate Address if Different From Above)	CHECK ONE			CHECK ONE			
		SUR-FACING	TSI	MISC	ACBM		ASSUMED ACBM	
					FRIABLE	NON-FRIABLE	FRIABLE	NON-FRIABLE
1.	Main Building - VFT 9" Tan with Speck-Mastic			X				X
2.	Main Building - Baseboard 2" Brown-Mastic			X				X
3.	Main Building - Drywall Medium Texture			X				X
4.	Main Building - ACT 12" Random Hole			X				X
5.	Main Building - Carpet Blue Multi-Mastic			X				X
6.	Main Building - Ceramic tile 4" Grey w/Grout			X				X
7.	Main Building - Linoleum Tan Squares-Mastic			X				X
8.	Main Building - Baseboard 6" Tan-Mastic			X				X
9.	Main Building - Drywall Smooth Texture			X				X
10.	Main Building - FRP White with Scratch Pattern-Mastic			X				X
11.	Main Building - VFT 9" Beige with Speck-Mastic			X				X
12.	Main Building - Baseboard 4" Brown-Mastic			X				X
13.	Main Building - Baseboard 4" Green-Mastic			X				X
14.	Main Building - Ceramic Tile 6" white w/Speck-Grout			X				X
15.	Main Building - FRP White w/Mastic			X				X
16.	Main Building - Carpet Blue-Mastic			X				X
17.	Main Building - Ceramic Tile Light Yellow w/Grout			X				X
18.	Main Building - HVAC Duct Tape			X				X
19.	Main Building - Foil Tape			X				X
20.	Main Building - CMU-Mortar			X				X
21.	Main Building - Carpet Green-Mastic			X				X

See attached 'Homogeneous Materials Records' for all materials and their locations by building. On Form B all buildings are listed, and a summary of all non-friable and friable materials is provided. Friable materials and their locations are listed separately under each building on Form B.

Date Printed: 8/19/2014

HAZARD MANAGEMENT SERVICES, INC.

PHYSICAL AND HAZARD ASSESSMENT OF FRIABLE ACBM OR FRIABLE ASSUMED ACBM (SEC. 763.93) (FORM C)

DISTRICT	Central California Conference of 7th Day Adventist	CDS CODE	43-69393-6980353
SCHOOL	West Valley S.D.A Elementary	SCHOOL PHONE NUMBER	(408) 378 - 4327
ADDRESS	95 Dot Avenue Campbell, CA 95008		
BUILDING NAME		INSPECTION DATE	May 20, 2014
FUNCTIONAL SPACE		LINE NO. FROM FORM B	

TYPE OF FRIABLE ACBM

1. CONDITION OF ACBM (Overall Rating)

2. POTENTIAL FOR DISTURBANCE (Overall Rating)

3. HAZARD ASSESSMENT (Combine Ratings From Items 1 and 2 and Check Appropriate Box)

CONDITION OF ACBM	POTENTIAL FOR DISTURBANCE		
	LOW	MODERATE	HIGH
GOOD	1	2	3
DAMAGED	4	5	6
SIGNIFICANTLY DAMAGED	7	7	7

4. RECOMMENDED RESPONSE ACTION(S) AND COST(S)

RESPONSE ACTION	ESTIMATED COSTS
<input type="checkbox"/> A. OPERATION AND MAINTENANCE	\$
<input type="checkbox"/> B. REPAIR	\$
<input type="checkbox"/> C. ENCAPSULATION	\$
<input type="checkbox"/> D. ENCLOSURE	\$
<input type="checkbox"/> E. REMOVAL	\$
Total Cost	\$

5. NARRATIVE OF RECOMMENDED RESPONSE

(Attach Additional Sheets If Necessary)

SCHEDULE

START FINISH

Comments:

NO RESPONSE ACTION NECESSARY.

Six Month Surveillance Summary

District: Central California Conference of 7th
Day Adventist

Date:

School: West Valley S.D.A Elementary

Inspector:

Building	HMR Number	Asbestos Material	Location	Condition Code/Comments
Main Building	1	VFT 9" Tan with Speck-Mastic	01-Hallway, 08-Teachers Workroom, 14-A5, 15-A5-HVAC Closet	
Main Building	2	Baseboard 2" Brown-Mastic	01-Hallway, 08-Teachers Workroom, 14-A5, 15-A5-HVAC Closet	
Main Building	3	Drywall Medium Texture	01-Hallway, 03-Grades K thru 2nd, 04-Grades 3 thru 4, 05-Custodial Closet, 06-Women's Restroom Foyer, 08-Teachers Workroom, 09-Kitchen, 10-Men's Restroom Foyer, 12-Second Floor Hallway, 13-A4-Music, 14-A5, 15-A5-HVAC Closet, 17-A3-Classroom, 18-Attic-First Floor, 18-Office, 19-Small Office, 20-Princiipal's Office	
Main Building	4	ACT 12" Random Hole	01-Hallway, 03-Grades K thru 2nd, 04-Grades 3 thru 4, 08-Teachers Workroom, 12-Second Floor Hallway, 13-A4-Music, 14-A5, 17-A3-Classroom	
Main Building	5	Carpet Blue Multi-Mastic	03-Grades K thru 2nd, 04-Grades 3 thru 4, 13-A4-Music, 17-A3-Classroom	
Main Building	6	Ceramic tile 4" Grey w/Grout	04-Grades 3 thru 4, 08-Teachers Workroom	
Main Building	7	Linoleum Tan Squares-Mastic	06-Women's Restroom Foyer, 07-Women's Restroom, 10-Men's Restroom Foyer, 11-Men's Restroom	
Main Building	8	Baseboard 6" Tan-Mastic	06-Women's Restroom Foyer, 07-Women's Restroom, 10-Men's Restroom Foyer, 11-Men's Restroom	
Main Building	9	Drywall Smooth Texture	07-Women's Restroom, 09-Kitchen, 11-Men's Restroom	
Main Building	10	FRP White with Scratch Pattern-Mastic	07-Women's Restroom	
Main Building	11	VFT 9" Beige with Speck-Mastic	09-Kitchen	

Condition Codes

General Condition: (1) Good (2) Damaged (3) Significantly Damaged (Damaged 25% or more)
 Change in Condition: (4) No (5) Yes (If yes, explain under comments)
 Abated: (6) Repaired (7) Removed (8) Encapsulated (9) Enclosed (10) Isolated & Restricted
 Misc: (11) Inaccessible, No surveillance data (12) Other (Explain under comments)

Six Month Surveillance Summary

District: Central California Conference of 7th
Day Adventist

Date:

School: West Valley S.D.A Elementary

Inspector:

Building	HMR Number	Asbestos Material	Location	Condition Code/Comments
Main Building	12	Baseboard 4" Brown-Mastic	09-Kitchen	
Main Building	13	Baseboard 4" Green-Mastic	09-Kitchen	
Main Building	14	Ceramic Tile 6" white w/Speck-Grout	09-Kitchen	
Main Building	15	FRP White w/Mastic	11-Men's Restroom	
Main Building	16	Carpet Blue-Mastic	12-Second Floor Hallway, 19-Small Office	
Main Building	17	Ceramic Tile Light Yellow w/Grout	13-A4-Music, 17-A3-Classroom	
Main Building	18	HVAC Duct Tape	15-A5-HVAC Closet	
Main Building	19	Foil Tape	15-A5-HVAC Closet	
Main Building	20	CMU-Mortar	17-A3-Classroom	
Main Building	21	Carpet Green-Mastic	18-Office, 20-Princiipal's Office	

Condition Codes

General Condition: (1) Good (2) Damaged (3) Significantly Damaged (Damaged 25% or more)
 Change in Condition: (4) No (5) Yes (If yes, explain under comments)
 Abated: (6) Repaired (7) Removed (8) Encapsulated (9) Enclosed (10) Isolated & Restricted
 Misc: (11) Inaccessible, No surveillance data (12) Other (Explain under comments)